

## HEAVY DUTY SHEAVES - CAST - REPLACEMENT PARTS



### STANDARD SHEAVES

Miller Heavy Duty Sheaves are now available in newly-designed, wear-resistant, cast alloy steel for both **Miller Hi-Lift Standard Crane Blocks** and for **Miller Mobile Crane Blocks**.

Features of the new designs include a selection of D/d ratios by sheave diameter and wire rope size, a new shape for increased structural strength, more weight for today's higher and heavier overhaul requirements, and the ability to alter wire groove details to allow compliance with certain industry standards including API2C.

Miller Hi-Lift Blocks are furnished standard with new-design, cast alloy steel sheaves and with cylindrical roller bearings up to 20" diameter and with tapered roller bearings for 24" and larger diameters.

Miller Mobile Crane Blocks are furnished standard with new-design, cast alloy steel sheaves with full-complement cylindrical double roller bearings.

Cast alloy steel sheaves are available in standard sizes from 8" to 36" in diameter and are listed in the succeeding tables. Sheaves are available with bare bore, or with bearings or SAE 660 bronze bushings. Stainless steel versions of the sheaves in the following tables are also available. Available with grease fitting by request, lubrication through the sheave pin is recommended. Standard groove angle is 30° minimum and groove radii meet API requirements.

### CUSTOM SHEAVES

Custom cast sheaves weighing up to 4 tons and to 120" diameter are available to your requirements. Roll-formed sheaves are produced to your requirements up to a diameter of 130". See the sheave request for quotation form in this section and specify cast or formed, or include your drawing. All sheaves can be manufactured to accommodate special requirements (e.g., API, ABS).



## HEAVY DUTY SHEAVES - CAST - REPLACEMENT PARTS

### HI-LIFT BEARING TYPE ROLLER

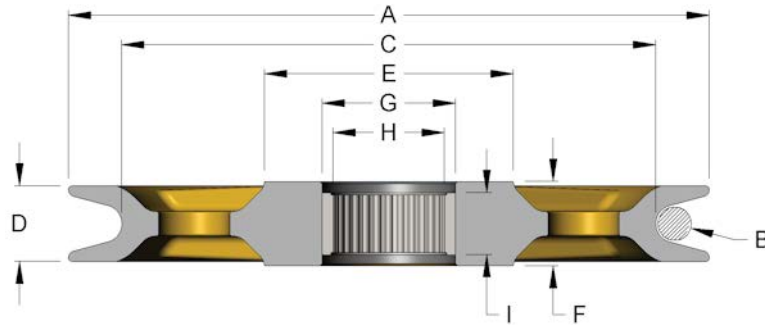

A (in.)	B (in.)	C (in.)	D (in.)	E (in.)	F (in.)	G (in.)	H (in.)	I (in.)	D/d RATIO	WEIGHT Lbs.
8	5/16	6.91	1.16	3.38	1.25	2.19	1.63	1.25	23	11
8	3/8	6.78	1.16	3.38	1.25	2.19	1.63	1.25	19	11
8	7/16	6.58	1.16	3.38	1.25	2.19	1.63	1.25	16	10
8	1/2	6.5	1.16	3.38	1.25	2.19	1.63	1.25	14	10
10	7/16	8.47	1.19	3.54	1.25	2.19	1.63	1.25	20	17
10	1/2	8.37	1.19	3.54	1.25	2.19	1.63	1.25	18	17
10	9/16	8.31	1.19	3.54	1.25	2.19	1.63	1.25	16	16
10	5/8	8.28	1.19	3.54	1.25	2.19	1.63	1.25	14	16
12	1/2	10.25	1.75	5.64	2	3.25	2.5	1.75	22	39
12	9/16	10.03	1.75	5.64	2	3.25	2.5	1.75	19	38
12	5/8	9.81	1.75	5.64	2	3.25	2.5	1.75	17	36
12	3/4	9.75	1.75	5.64	2	3.25	2.5	1.75	14	35
14	1/2	12.25	1.75	5.66	2	3.25	2.5	1.75	26	44
14	9/16	12.03	1.75	5.66	2	3.25	2.5	1.75	22	42
14	5/8	11.81	1.75	5.66	2	3.25	2.5	1.75	20	41
14	3/4	11.75	1.75	5.66	2	3.25	2.5	1.75	17	40
16	9/16	14.03	2	6.6	2.38	3.75	3	1.75	26	67
16	5/8	13.81	2	6.6	2.38	3.75	3	1.75	23	65
16	3/4	13.56	2	6.6	2.38	3.75	3	1.75	19	62
16	7/8	13.37	2	6.6	2.38	3.75	3	1.75	16	60
18	5/8	15.81	2.13	6.99	2.38	3.75	3	1.75	26	90
18	3/4	15.37	2.13	6.99	2.38	3.75	3	1.75	21	85
18	7/8	15.16	2.13	6.99	2.38	3.75	3	1.75	18	81
18	1	15	2.13	6.99	2.38	3.75	3	1.75	16	78
20	3/4	17.37	2.31	7.61	2.5	4.25	3.25	2	24	112
20	7/8	16.94	2.31	7.61	2.5	4.25	3.25	2	20	106
20	1	16.75	2.31	7.61	2.5	4.25	3.25	2	18	101
20	1-1/8	16.62	2.31	7.61	2.5	4.25	3.25	2	16	98
20	3/4	17.37	2.31	7.61	2.5	4.5	3.5	2	24	112
20	7/8	16.94	2.31	7.61	2.5	4.5	3.5	2	20	106
20	1	16.75	2.31	7.61	2.5	4.5	3.5	2	18	101
20	1-1/8	16.62	2.31	7.61	2.5	4.5	3.5	2	16	98

# HEAVY DUTY SHEAVES - CAST - REPLACEMENT PARTS

## HI-LIFT BEARING TYPE TAPERED ROLLER

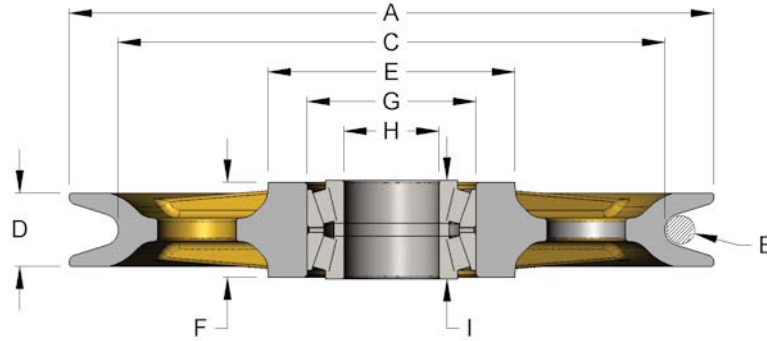

A (in.)	B (in.)	C (in.)	D (in.)	E (in.)	F (in.)	G (in.)	H (in.)	I (in.)	D/d RATIO	WEIGHT Lbs.
24	7/8	20.94	2.75	9.18	3.56	6	3.5	3.625	25	200
24	1	20.5	2.75	9.18	3.56	6	3.5	3.625	22	189
24	1-1/8	20.34	2.75	9.18	3.56	6	3.5	3.625	19	185
24	1-1/4	20.25	2.75	9.18	3.56	6	3.5	3.625	17	182
30	1-1/8	25.63	3	8.03	3.63	7.19	5	3.688	22	176
30	1-1/4	25.63	3	8.03	3.63	7.19	5	3.688	21	171
30	1-3/8	25.63	3	8.03	3.63	7.19	5	3.688	20	166

**MILLER LIFTING PRODUCTS**

**CRANE ATTACHMENTS**

**MILLER LOAD BLOCK**

1. REMOVE UNDESIRABLE WORN PARTS
2. CHECK FOR CRACKS
3. HEAVY DUTY TAPERED ROLLER
4. CHECK FOR CRACKS
5. CHECK FOR CRACKS
6. CHECK FOR CRACKS
7. CHECK FOR CRACKS
8. CHECK FOR CRACKS
9. CHECK FOR CRACKS
10. CHECK FOR CRACKS

**MILLER OVERHAUL BALL**

1. REMOVE UNDESIRABLE WORN PARTS
2. CHECK FOR CRACKS
3. HEAVY DUTY TAPERED ROLLER
4. CHECK FOR CRACKS
5. CHECK FOR CRACKS
6. CHECK FOR CRACKS
7. CHECK FOR CRACKS
8. CHECK FOR CRACKS
9. CHECK FOR CRACKS
10. CHECK FOR CRACKS

## HEAVY DUTY SHEAVES - CAST - REPLACEMENT PARTS

### MCB BEARING TYPE FULL COMPLEMENT ROLLER

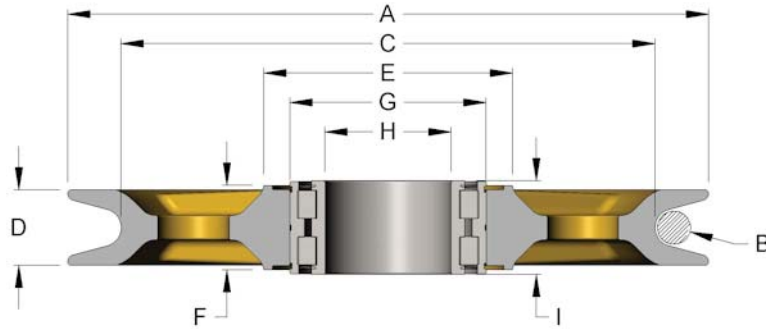

A (in.)	B (in.)	C (in.)	D (in.)	E (in.)	F (in.)	G (in.)	H (in.)	I (in.)	D/d RATIO	WEIGHT Lbs.
10	7/16	8.47	1.5	4.7	1.75	3.54	2.17	1.81	20	23
10	1/2	8.37	1.5	4.7	1.75	3.54	2.17	1.81	18	23
10	9/16	8.17	1.5	4.7	1.75	3.54	2.17	1.81	16	22
10	5/8	8.12	1.5	4.7	1.75	3.54	2.17	1.81	14	21
12	1/2	10.25	1.75	5.64	2	4.33	2.76	2.13	22	38
12	9/16	10.03	1.75	5.64	2	4.33	2.76	2.13	19	37
12	5/8	9.81	1.75	5.64	2	4.33	2.76	2.13	17	35
12	3/4	9.75	1.75	5.64	2	4.33	2.76	2.13	14	34
14	1/2	12.25	1.75	5.66	2	4.33	2.76	2.13	26	43
14	9/16	12.03	1.75	5.66	2	4.33	2.76	2.13	22	41
14	5/8	11.81	1.75	5.66	2	4.33	2.76	2.13	20	40
14	3/4	11.75	1.75	5.66	2	4.33	2.76	2.13	17	38
16	9/16	14.03	2	6.61	2.25	5.12	3.35	2.36	26	65
16	5/8	13.81	2	6.61	2.25	5.12	3.35	2.36	23	63
16	3/4	13.56	2	6.61	2.25	5.12	3.35	2.36	19	60
16	7/8	13.37	2	6.61	2.25	5.12	3.35	2.36	16	57
18	5/8	15.81	2.13	6.99	2.38	5.51	3.54	2.64	26	88
18	3/4	15.37	2.13	6.99	2.38	5.51	3.54	2.64	21	83
18	7/8	15.16	2.13	6.99	2.38	5.51	3.54	2.64	18	79
18	1	15	2.13	6.99	2.38	5.51	3.54	2.64	16	76
20	3/4	17.37	2.31	7.61	2.5	5.91	3.94	2.64	24	109
20	7/8	16.94	2.31	7.61	2.5	5.91	3.94	2.64	20	103
20	1	16.75	2.31	7.61	2.5	5.91	3.94	2.64	18	98
20	1-1/8	16.62	2.31	7.61	2.5	5.91	3.94	2.64	16	95
24	7/8	20.94	2.75	9.2	3.11	7.09	4.72	3.15	25	185
24	1	20.5	2.75	9.2	3.11	7.09	4.72	3.15	22	174
24	1-1/8	20.34	2.75	9.2	3.11	7.09	4.72	3.15	19	170
24	1-1/4	20.25	2.75	9.2	3.11	7.09	4.72	3.15	17	167